

DETAIL E
MABSTAB 1 : 1

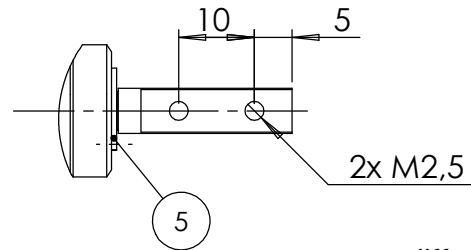

POS-NR.	DESCRIPTION	MATERIAL	Qty
1	rotary/linear push pull drive		1
1.1	flange DN40 CF	1.4404 (316L)	1
1.2	Tube 6x1	1.4301 (X5CrNi18-10)	1
1.3	Flange DN16 KF	1.4301 (X5CrNi18-10)	1
1.4	Ultratorr vacuum adapter 6.35	Stainless Steel	2
2	knob	Al Alloy	1
3	Hexagon Nut M6	Stainless Steel	1
4	Axis 6	1.4305 (303)	1
5	Lock washer	Stainless Steel	1

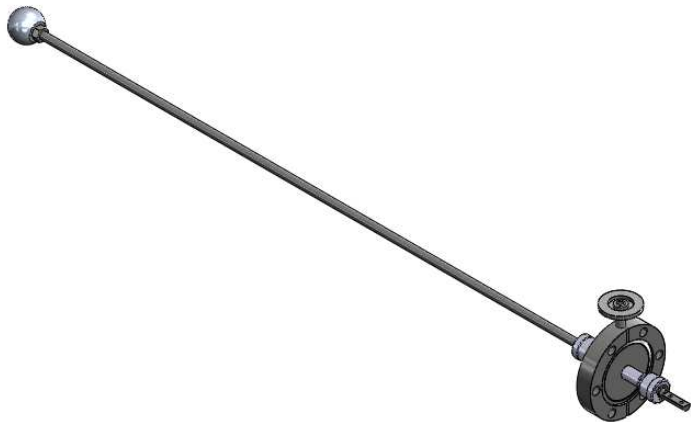
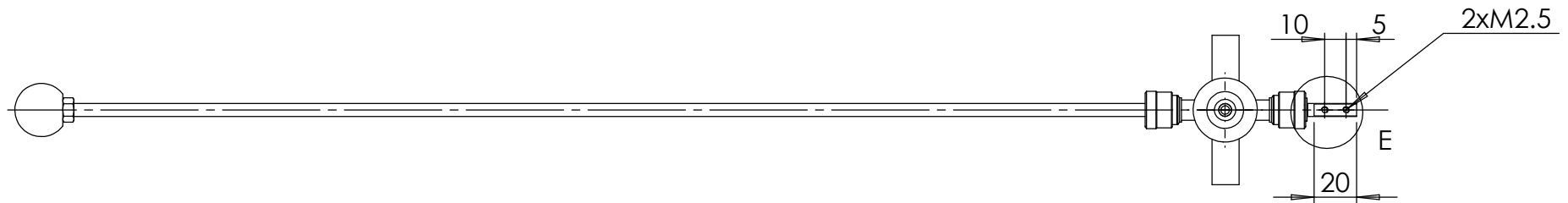
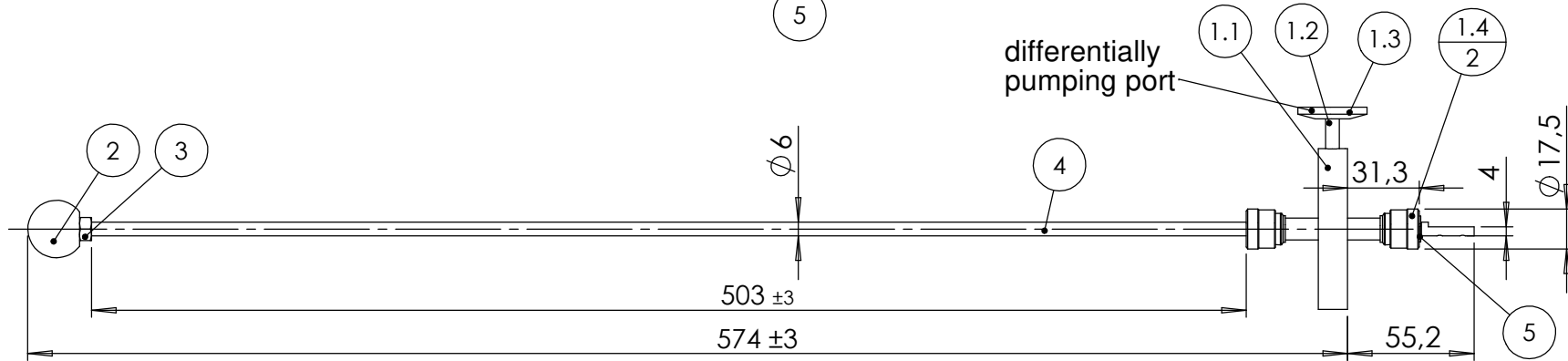

Bemerkungen (Remarks)				Freimaßtoleranz (Standard Toleranz)		Maßstab (Scale)	Rauheit (Roughness)		europ.Projektion			
All informations provided in this drawing is considered to be confidential, proprietary and secret information. If is intended only for the use of individual or entity to whom it is sent. Individual or entity agrees to not disseminate or copy this information to anyone other than originally specified without the written consent Allectra GmbH.						1:3						
				Material, Standard							Kanten (edges)	
				Oberfläche (Treatment)								
				Design	21.01.2020	JB	Bezeichnung (Title)		Gewicht (weight) 9			
				Drawn	22.01.2020	JB	rotary/linear push pull drive travel 500mm, varia DN40 CF		Page: 3			
				Check					Pages: 3			
							Zeichnungsnummer (Drawing No.)		Revision			
							613-RLD500-DP-C40					
Index	Modification	Datum	Name	Datei (File)		C:\PDMStore\C:\PDMStore\		Format A4				