

POS.	DESCRIPTION	MATERIAL	QTY
1	modified flange DN40 KF	1.4301 (304)	1
2	1 pair Thermocouple f/t type K	stainless steel	1

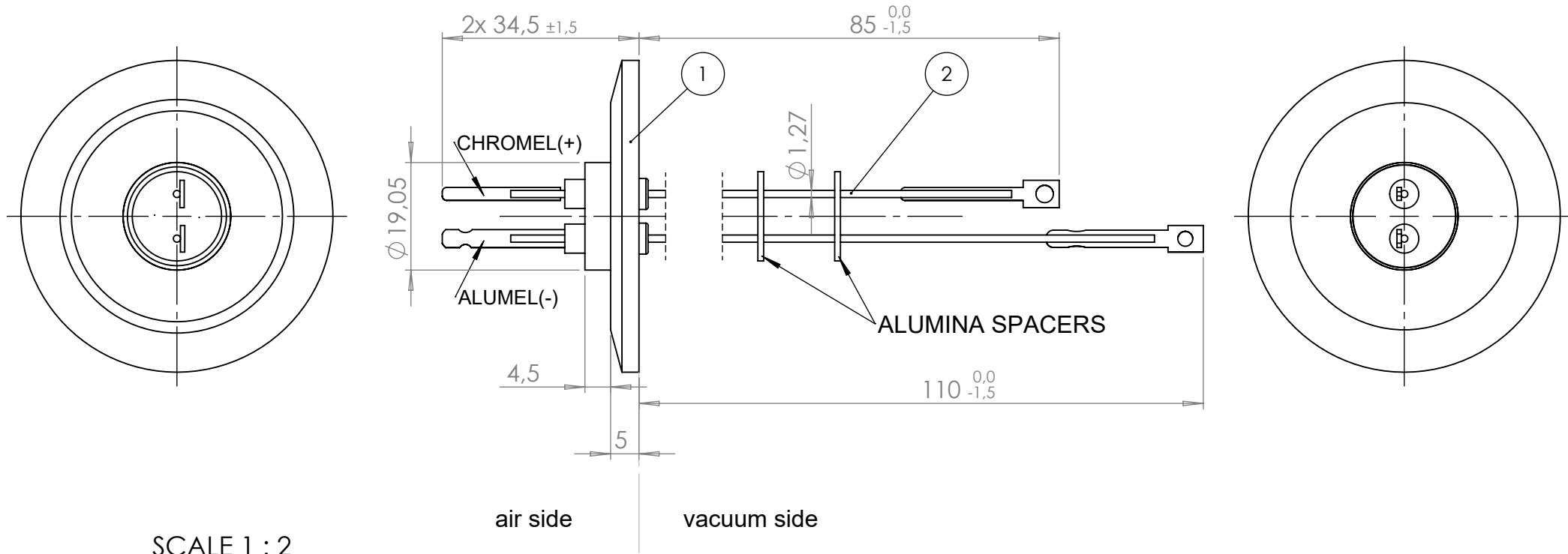

SCALE 1 : 2

air side connector included

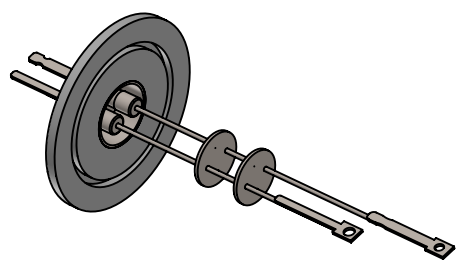

<1x10 E-9 bar*/l/sec, according DIN EN 1779
Definition Leckprüfung (definiton leak check)

Zeichnung Nutzung (using drawing) Drawing external use for customer		Verwendetes Material (USED MATERIAL)		Bemerkung (REMARKS)		Kanten (EDGES)		PROJECTION					
All informations provided in this drawing is considered to be confidential, proprietary and secret information. It is intended only for the use of individual or entity to whom it is sent. Individual or entity agrees to not disseminate or copy this information to anyone other than originally specified without the written consent Alletra GmbH.		Werkstoff (MATERIAL): Gewicht (WIGHT):		Toleranz (TOLERANCE) DIN EN 1390-C (welding ASSY)									
		Oberfläche (SURFACE) Cleaned UHV- Compatible								g			
		Maßstab (SCALE):		Format. (FORM)		PAGE NO		PAGES					
		1:1		A4		1		1					
		Rauheit (ROUGHNESS)											
origin		name		DATE		Benennung (DESCRIPTION):							
		Alletra standard				Thermocouple f/t, Type K, 1 pair on flange DN40 KF							
		(drw/doc/sketch)		Design						05.01.2024		AD	
		date		Drawn						05.01.2024		AD	
				Check						05.01.2024		JB	
00		first origin		Approv		05.01.2024		AD					
						Zeich. Nr. (Drw. No.):				REV			
						262-TCK-1-K40				00			
REV		Beschreibung (CHANGING)		gesp. am (SAVE DAT.):		05.01.2024		Art. Nr. (PART NO.) 262-TCK-1-K40					