

POS. NO.	DESCRIPTION	MATERIAL	QTY
1	SHV connector female, RG58, modified	Silver plated	1
2	viton tube 5x5	VITON	1
3	viton tube 3x22	VITON	1

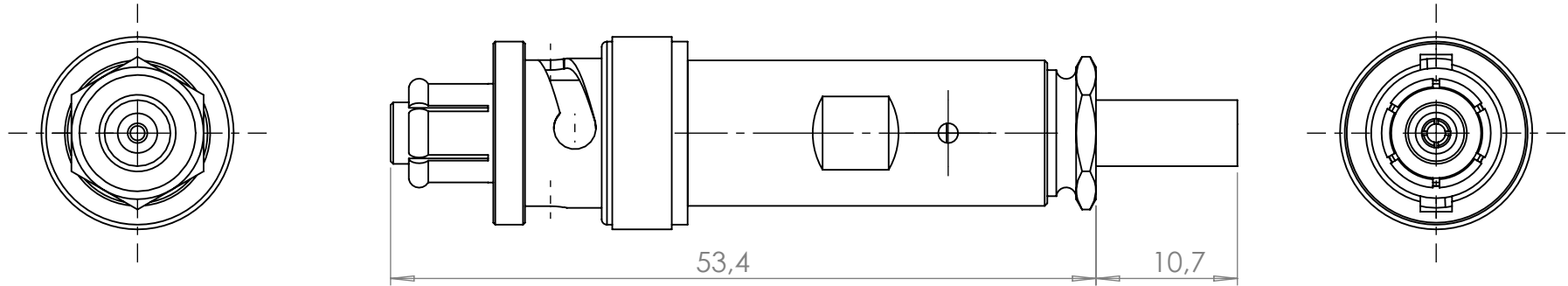

SCALE 1 : 1

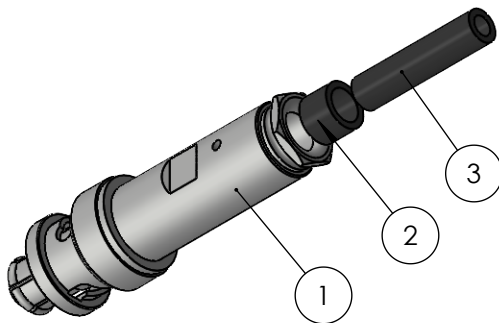

no leakcheck required  
Definition Leckprüfung (definon leak check)

Zeichnung Nutzung (SCOPE OF DRAWING) Drawing external usage for customer		Verwendetes Material (USED MATERIAL)		Bemerkung (REMARKS)		Kanten (EDGES)		PROJECTION		
All informations provided in this drawing is considered to be confidential, proprietary and secret information. It is intended only for the use of individual or entity to whom it is sent. Individually or entity agrees to not disseminate or copy this information to anyone other than originally specified without the written consent Allectra GmbH.		Werkstoff (MATERIAL):		Toleranz (TOLERANCE)						
		Gewicht (WEIGHT): g								
Oberfläche (SURFACE) Cleaned UHV- Compatible		Maßstab (SCALE): 2:1	Format. (FORM) A4	PAGE NO 1	PAGES 1	Rauheit (ROUGHNESS) $\sqrt{Rz\ 16\ (Rz\ 6.3)}$				
origin	name	Allectra standard		DATE	NAME	Benennung (DESCRIPTION): SHV coaxial connector (female) 5A/5kV, RG174 (KAP50)				
	(drw/doc/sketch)			Design	22.03.2024					JB
	date			Drawn	25.03.2024					JB
				Check	25.03.2024					NH
00	first origin			Approv	26.03.2024	JB	Zeich. Nr. (Drw. No.): 245-CON-SHV			REV 00
REV	Beschreibung (CHANGING)	gesp. am (SAVE DAT.): 26.03.2024		Art. Nr. (PART NO.) 245-CON-SHV						

