

Version VFT1.10 is shown

POS.	DESCRIPTION	MATERIAL	QTY
1	modified flange DN100 CF	1.4404 (316L)	1
2	6 pin feedthrough, type CM, weldable	Stainless Steel / Glas Ceramic	5

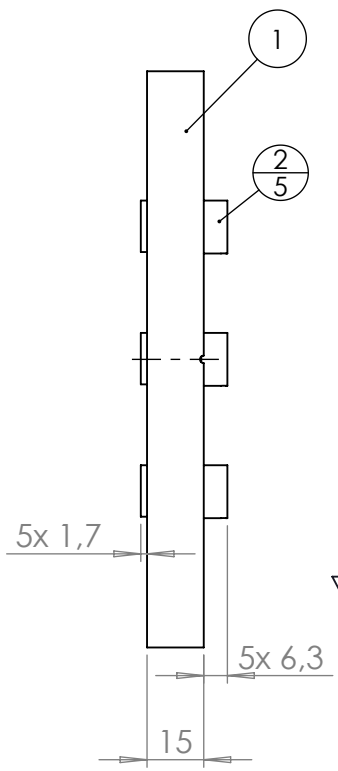
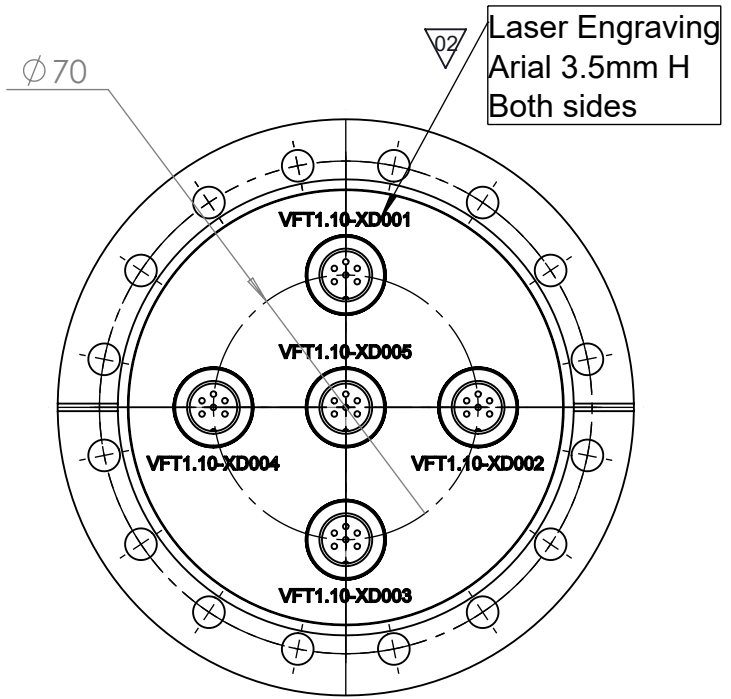

4 flanges to be engraved

Version	Laser engraving	Flange/QTY
VFT1.10	VFT1.10-XD001 VFT1.10-XD002 VFT1.10-XD003 VFT1.10-XD004 VFT1.10-XD005	2
VFT1.11	VFT1.11-XD001 VFT1.11-XD002 VFT1.11-XD003 VFT1.11-XD004 VFT1.11-XD005	2

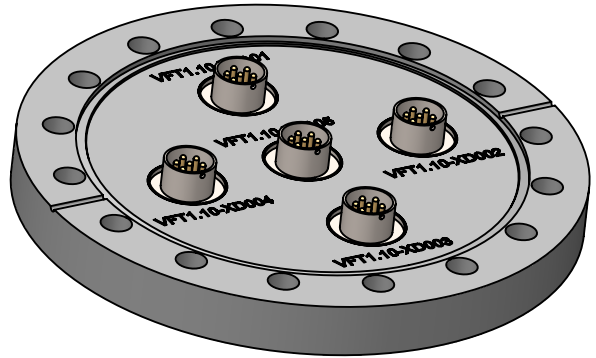
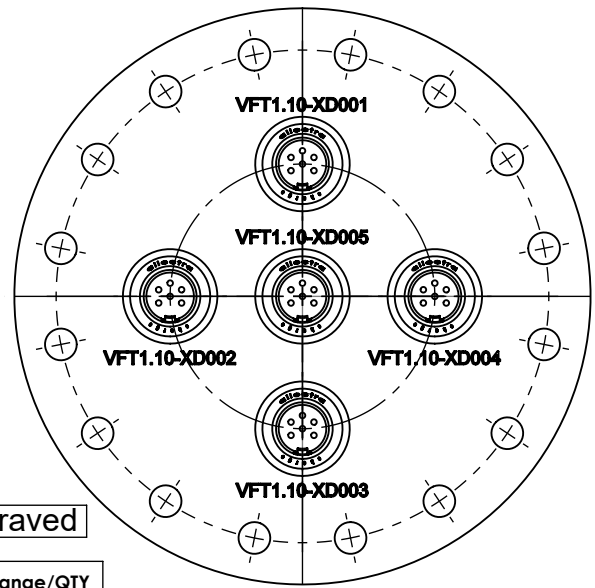

All informations provided in this drawing is considered to be confidential, proprietary and secret information. It is intended only for the use of individual or entity to whom it is sent. Individual or entity agrees to not disseminate or copy this information to anyone other than originally specified without the written consent Allectra GmbH.		Verwendetes Material (USED MATERIAL)		Bemerkung (REMARKS)		Kanten (EDGES)		PROJECTION	
Oberfläche (SURFACE) Cleaned UHV- Compatible		Rauheit (ROUGHNESS) √		Maßstab (SCALE): 1:2		Gewicht (WIGHT):		g	
origin name Customer		DATE NAME		Benennung (DESCRIPTION): 5 off CM6 f/t on flange DN100 CF		Bl. (page)		page pages	
origin Doc.No.EUVR8-BGD-SP-012		Design 16.06.2023 AD				A4		1 1	
(drw/sketch/part no)		Drawn 25.07.2023 AD							
date of origin 13.07.2023 REV 00		Check 25.07.2023 NH							
02 Engraving added		Approv 31.08.2023 AD		Zeich. Nr. (Drw. No.):				REV	
REV Beschreibung (CHANGING)		LAST SAVE DAT.: 31.08.2023		220S-CM6_5-C100-V1				02	
				part. no. 220S-CM6-C100-5-ENG					

