

cable diameter  
max, 4 mm

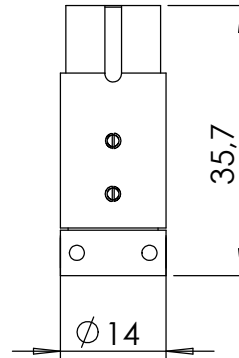

POS-NR.	DESCRIPTION	MATERIAL	QTY
1	SR housing for CM 6		1
1.1	housing for 6 pin SR connector	1.4404 (316L)	1
1.2	SCREW-M2x8	Stainless Steel	2
1.3	clamp for SR housing	1.4571 (X6CrNiMoTi17-12-2)	1
1.4	shield clamp part	1.4404 (316L)	1
1.5	GRUB SCREW-M2X2	Stainless Steel	1
1.6	Grub Screw M2x3	Stainless Steel	1
2	connector UHV		1
2.1	front part insulator	PEEK (Natur)	1
2.2	Crimp Pin 1.3	Copper Alloy Gold plated	6
2.3	back part insulator	PEEK (Natur)	1
2.4	Countersunk Screw M2X16	Stainless Steel	1

front side  
S 2:1

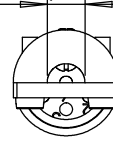
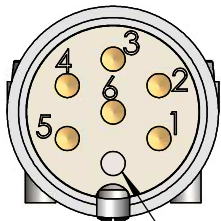

screw hole

back side  
S 2:1

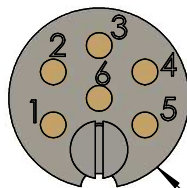

view  
without SR housing

Bemerkungen (Remarks)				Freimaßtoleranz (Standard Tolerance)	Maßstab (Scale)	Rauheit (Roughness)	europ.Projektion
All informations provided in this drawing is considered to be confidential, proprietary and secret information. If is intended only for the use of individual or entity to whom it is sent. Individual or entity agrees to not disseminate or copy this information to anyone other than originally specified without the written consent Allectra GmbH.					1:1		
				Datum	Name	<b>Bezeichnung (Title)</b>  <b>connector strain relief for 6 pin miniature f/t</b>	<b>Gewicht (weight)</b> <b>9</b>
			Design	23.04.2019	AD		
			Drawn	27.09.2022	AD		Page: 1 Pages: 1
			Check			<b>Zeichnungsnummer (Drawing No.)</b> <b>220-CON6-SR</b>	Revision
Index	Modification	Date	Name	Datei (File) C:\PDMstore\C:\PDMstore\			Format <b>A4</b>