

POS-NR.	DESCRIPTION	MATERIAL	QTY
1	Countersunk Screw M2X14	Stainless Steel	2
2	Front Plate for SUB-D 9 Pin	PEEK	1
3	Slotted Cheese Screw 4-40 UNC	1.4301 (X5CrNi18-10)	2
4	Back Plate for SUB-D 9 Pin	PEEK	1
5	Hexagon Nut M2 DIN934	Stainless Steel	2

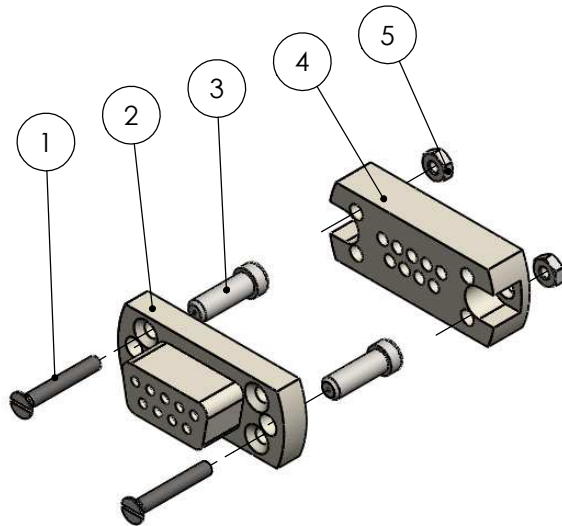
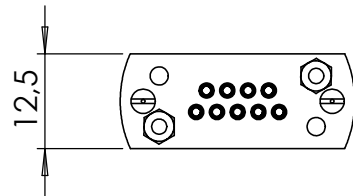
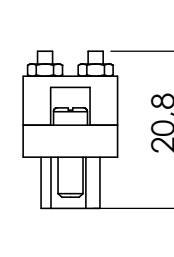
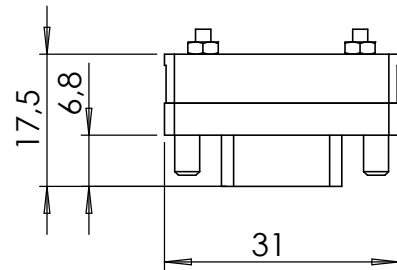
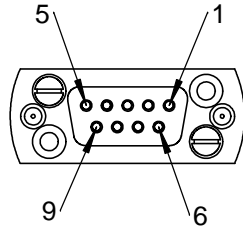

Bemerkungen (Remarks)				Freimaßtoleranz (Standard Toleranz)		Maßstab (Scale)	Rauheit (Roughness)	europ.Projektion			
<p>All informations provided in this drawing is considered to be confidential, proprietary and secret information. It is intended only for the use of individual or entity to whom it is sent. Individual or entity agrees to not disseminate or copy this information to anyone other than originally specified without the written consent Alletra GmbH.</p>						1:1					
								Material, Standard Oberfläche (Treatment)		Kanten (edges)	
								UHV connector 9 pin standard SUB-D		Gewicht (weight) 9	
Datum		Name		Bezeichnung (Title)		Page:		Pages:			
Design 28.02.2014		JB				1		10			
Drawn 22.06.2016		FW				Revision					
Check						Zeichnungsnummer (Drawing No.) 211-FS09-PK					
Index		Modification		Datum		Name		Datei (File) C:\PDMStore\IC\PDMStore\		Format A4	