

Z-Manipulators DN40CF: 621-ZLT-C40-xxx

(New versions from 6.2015)

Z-manipulators with a travel from 50mm to 600mm are offered from Allectra. Various options allow the use in many applications.

| | 50mm | 100mm | 150mm | 200mm | 300mm | 500mm |
|--------------|---|-------|-------|-------|-------|-------|
| Top flange | DN40CF metric tapped optional: DN40CF with through holes (+25mm) | | | | | |
| Base flange | DN40CF with through holes | | | | | |
| Vacuum | UHV Leak rate $<1 \times 10^{-10}$ mbar l/s | | | | | |
| Max. Bakeout | 230°C | | | | | |
| Bellow ID | 39mm | | | | | |
| Readout | 10 μ m | | | | | |
| A min (mm) | 75 | 90 | 105 | 120 | 150 | 225 |
| B (mm) | 221 | 286 | 351 | 416 | 546 | 821 |
| C (mm) | 104 | | | 109 | | |
| D (mm) | 103 | | | 110 | | |
| Options: | Permeability < 1.01 | | | | | |
| | Top flange with through holes | | | | | |
| | Hand wheel on side | | | | | |
| | Integrated X-Table | | | | | |
| | Other travels: 75mm / 250mm / 350mm / 400mm / 600mm and on request | | | | | |
| | Integrated port aligner | | | | | |
| | Stepper motor drive / limit switches | | | | | |
| | 2 stage / 3 stage pneumatic drive | | | | | |

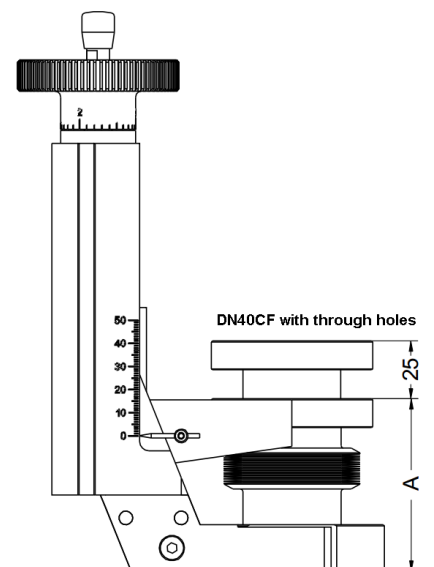
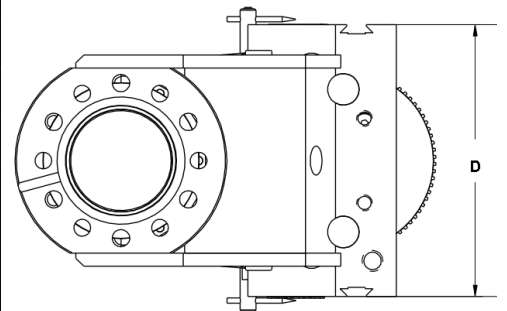
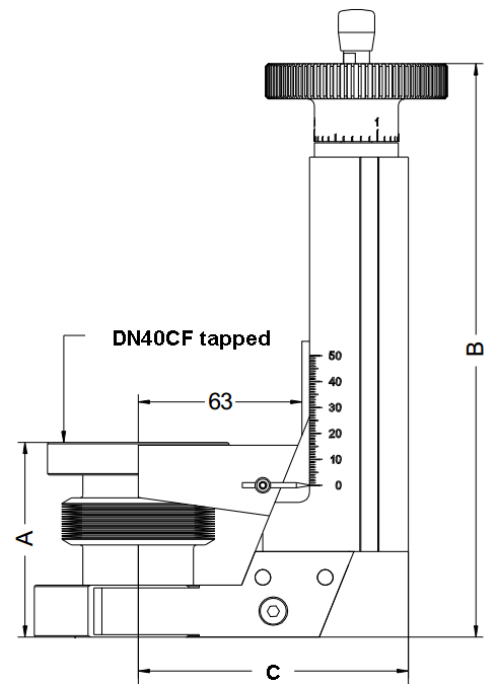

- The optional X-drive offers a movement of +/-6.5mm, a locking screw is included in the design
- The optional port aligner allows a travel or tilt of up to 10mm, the top flange has through holes



Version with optional port aligner

50mm travel manipulator with through hole option

File: 621-ZLT-C40-xxx Last revised 2018-04-27

All data given in this sheet are carefully checked but subject to change at any time.

| Type |
|--|
| 621-ZLT-C40-50 |
| 621-ZLT-C40-100 |
| 621-ZLT-C40-150 |
| 621-ZLT-C40-200 |
| 621-ZLT-C40-300 |
| 621-ZLT-C40-500 |
| Options: |
| Top flange DN40CF with though holes |
| Permeability <1.01 |
| Hand wheel on side |
| Integrated X-Table +/-6.5mm |
| Integrated port aligner (up to 250mm travel) |
| Stepper motor drive |
| limit switches |
| limit switches, bakeable |
| 2 stage / 3 stage pneumatic drive |

Please ask for a quote to get the right part code for your desired assembly.
Not all options can be combined.