

MPF PRODUCTS INC.

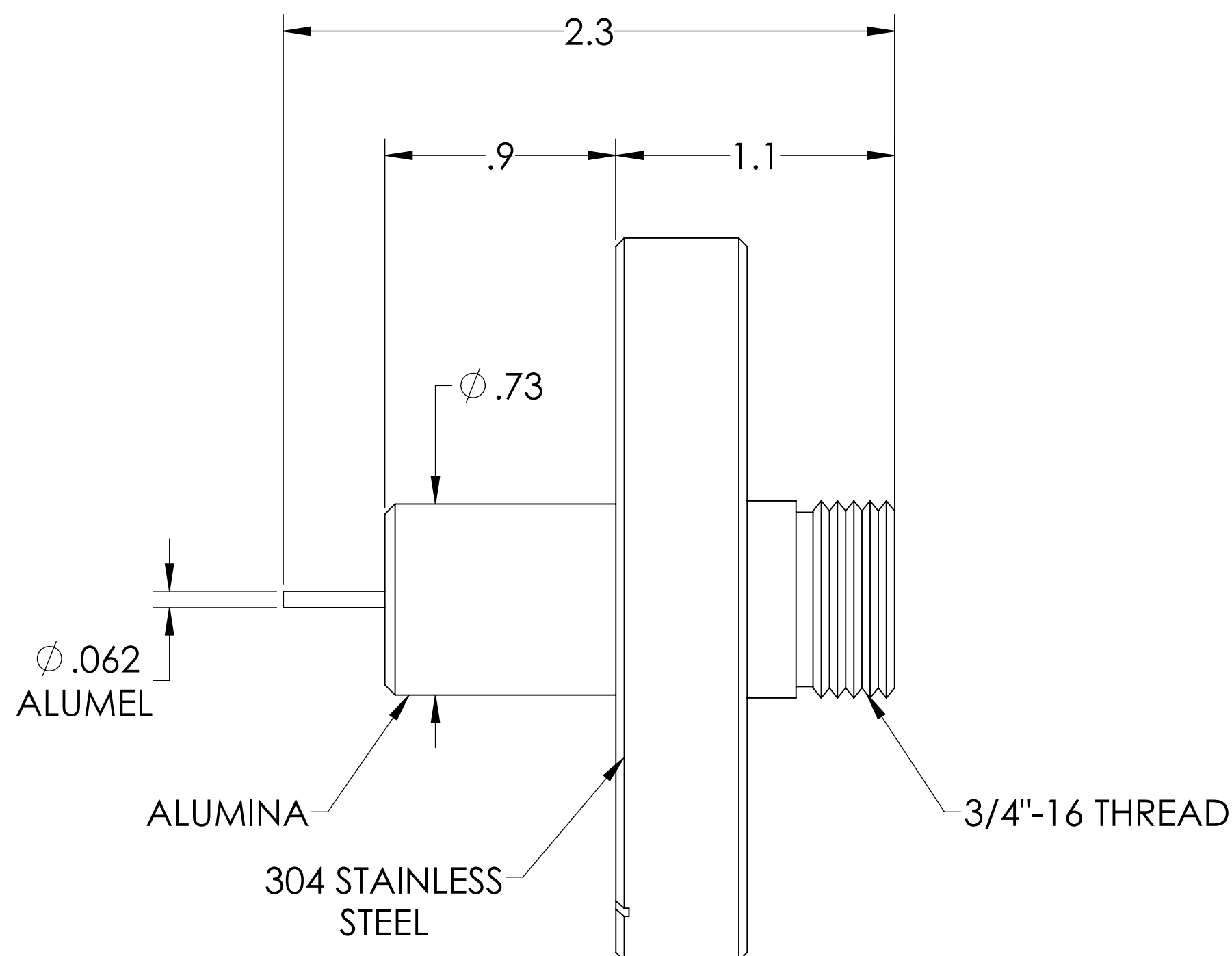

HVL CONNECTOR/CABLE

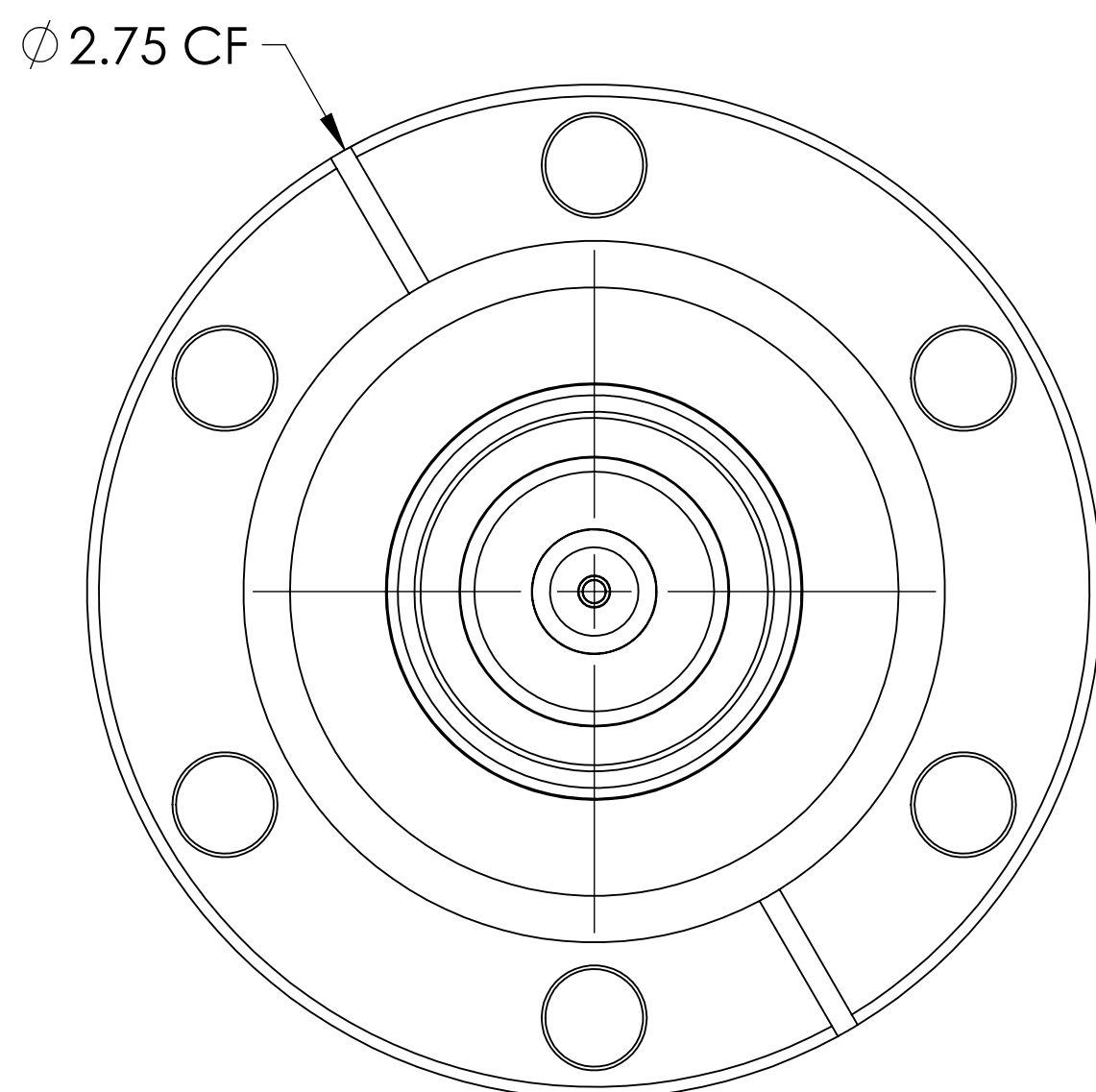
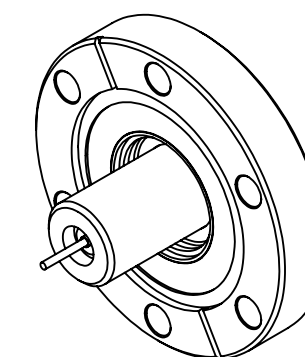
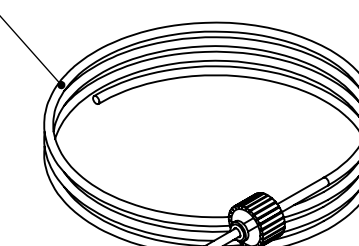

APPROVED
 24.10.2023, 07:58:52
 Jens Bohl

- NOTE:**
1. VOLTAGE: 40,000 VOLTS DC (WITH AIRSIDE PLUG)
 2. CURRENT: 10 AMPS
 3. TEMPERATURE RATING: -100 TO 450°C

Allectra Part.No. 265-007AL40K-C40

Power Feedthrough W/ 8' HVL Connector/Cable, 40 KV, 1 Pin, 2.75" Conflat Flange, UHV Rated, Bakeable to 450°C

UNLESS OTHERWISE SPECIFIED:		QUOTATION #		N/A	
DIMENSIONS ARE IN INCHES TOLERANCES:		NAME	DATE	MPF PRODUCTS INC.	
ANGULAR: MACH ± 1/2°		DRAWN	9/11/2015		
TWO PLACE DECIMAL ± .030		CHECKED	9/11/2015		
THREE PLACE DECIMAL ± .015		ENG APPR.	WJ 9/11/2015		
MATERIAL		THIRD ANGLE:		TITLE: POWER FEEDTHROUGH, 40 KV, 1 PIN, 2.75" CONFLAT FLANGE	
		APPLICATION			
		NEXT ASSY	USED ON	DOWNLOADED FROM MPFPI.COM	
FINISH		SURFACE FINISH: 63/ OR BETTER		DWG. NO.	REV
PLATING		UNLESS OTHERWISE SPECIFIED:		A2605-1-CF	
ALL DIAMETERS CONCENTRIC WITHIN .005. REMOVE ALL BURRS AND SHARP EDGES		Tues, Oct 22, 2019 11:35:23 AM			