

DETAIL A  
SCALE 2 : 1

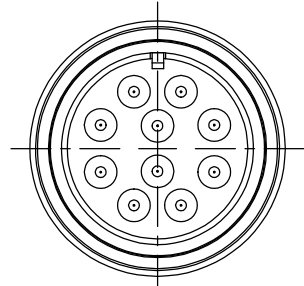

DETAIL B  
SCALE 1.5 : 1

○ Alumel conductor (-) with flat ends at vacuum side

● Chromel conductor (+) with radius ends at vacuum side

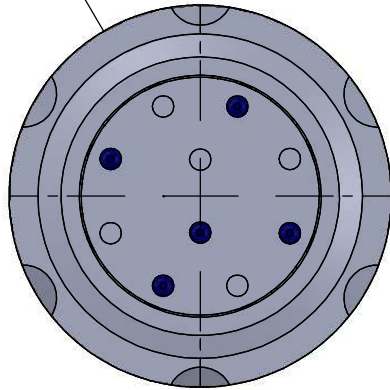

air side connector included

SCALE 1:2

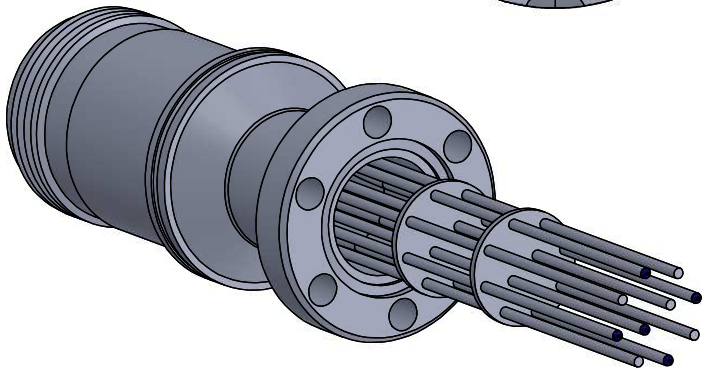
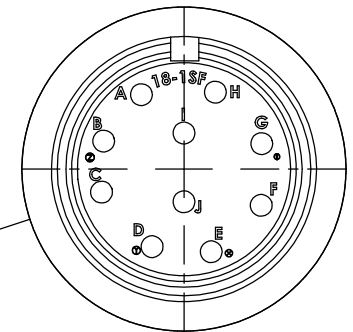
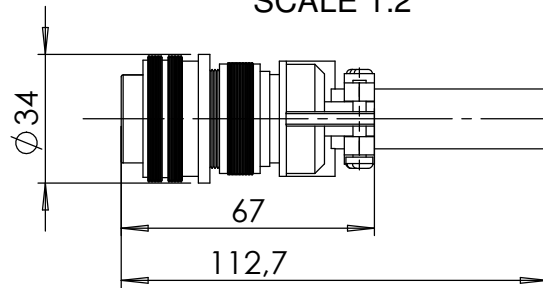

CHROMEL(+)	B,D,F,H,J
ALUMEL(-)	A,C,E,G,I

Bemerkungen (Remarks)				Freimaßtoleranz (Standard Tolerance)		Maßstab (Scale)		Rauheit (Roughness)		europ. Projektion	
All informations provided in this drawing is considered to be confidential, proprietary and secret information. If is intended only for the use of individual or entity to whom it is sent. Individual or entity agrees to not disseminate or copy this information to anyone other than originally specified without the written consent Alletra GmbH.				Datum		Name		Material, Standard Oberfläche (Treatment)		Kanten (edges)	
				Design 20.11.2020		JB					
				Drawn 14.12.2022		AD					
Index				Modification		Date		Name		Gewicht (weight) 9	
								Bezeichnung (Title)		Page: 1 Pages: 1	
								thermo couple f/t (type K) 5 pairs on flange DN16 CF		Revision	
								Zeichnungsnummer (Drawing No.) 263-TCK-MS-5-C16		Format A4	
								Datei (File) C:\PDMstore\C:\PDMstore\			

