

POS-NR.	DESCRIPTION	Material	QTY
1	Front Plate for SUB-D 50 Pin	PEEK	1
2	Back Plate for SUB-D 50 Pin	PEEK	1
3	Hexagon Nut M2 DIN934	Stainless Steel	2
4	Screw M2.5 x 30	Stainless Steel	2
5	Hexagon Nut M2.5	Stainless Steel	2
6	Countersunk Screw M2x20	Stainless Steel	2

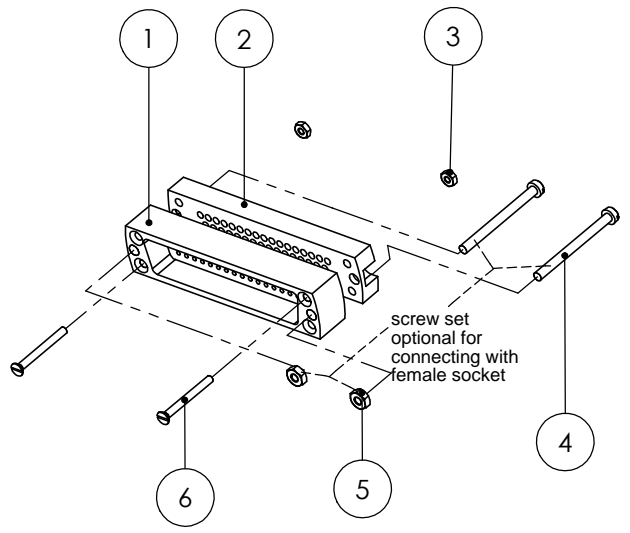
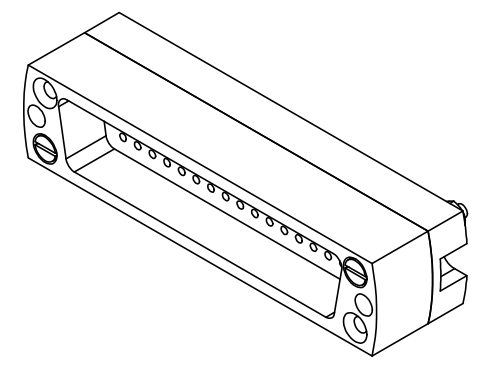
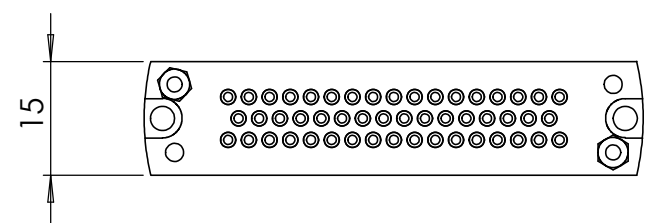
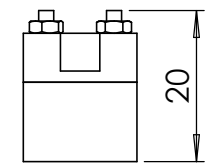
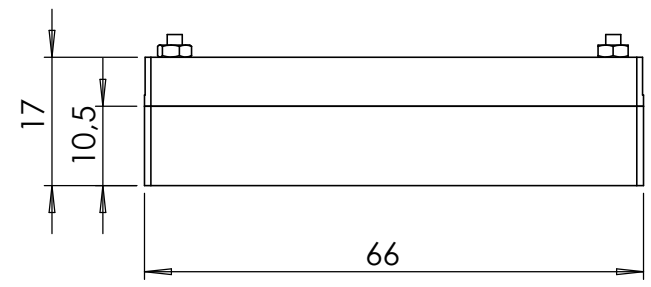
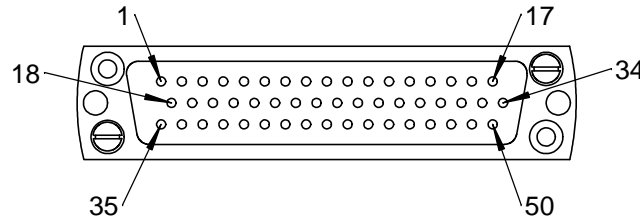

Bemerkungen (Remarks)				Freimaßtoleranz (Standard Toleranz)		Maßstab (Scale)	Rauheit (Roughness)		europ.Projektion	
All informations provided in this drawing is considered to be confidential, proprietary and secret information. It is intended only for the use of individual or entity to whom it is sent. Individual or entity agrees to not disseminate or copy this information to anyone other than originally specified without the written consent Alletra GmbH.				Datum		1:1				
				Name						
				Design	28.02.2014	JB	Material, Standard Oberfläche (Treatment) Bezeichnung (Title) <b>UHV connector 50 pin standard SUB-D</b>		Kanten (edges)	
				Drawn	05.07.2016	FW			Gewicht (weight) <b>g</b>	
				Check					18.04	
								Page: <b>7</b> Pages: <b>7</b>		Revision
								Format <b>A4</b>		
Index	Modification	Datum	Name				Zeichnungsnummer (Drawing No.) <b>211-MS50-PK</b>			
							Datei (File) C:\PDMStore\IC\PDMStore\			