

POS-NR.	DESCRIPTION	MATERIAL	QTY
1	Front Plate for SUB-D 26 Pin male	PEEK (Natur)	1
2	Crimp PIN 0.7mm	Copper Alloy Gold plated	26
3	Back Plate for SUB-D 26 Pin	PEEK (Natur)	1
4	Hexagon Nut M2 DIN934	Stainless Steel	2
5	Countersunk Screw M2x20	Stainless Steel	2
6	Hexagon Nut M2.5	Stainless Steel	2
7	Screw M2.5 x 30	Stainless Steel	2

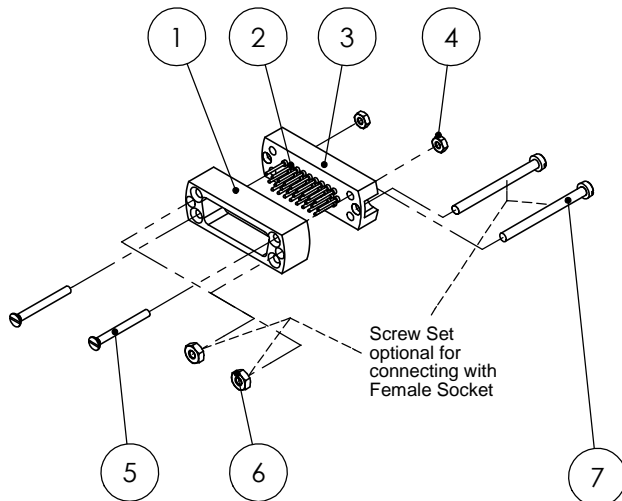
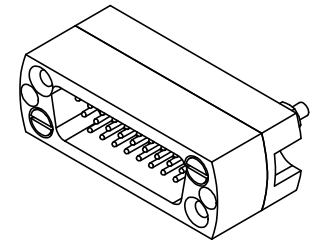
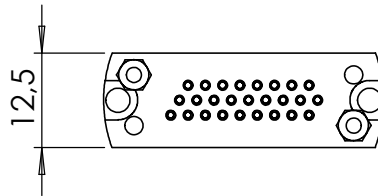
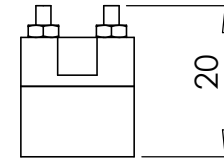
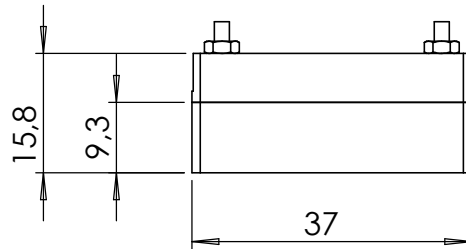
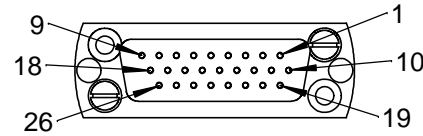

Bemerkungen (Remarks)				Freimaßtoleranz (Standard Toleranz)		Maßstab (Scale)	Rauheit (Roughness)	europ.Projektion		
All informations provided in this drawing is considered to be confidential, proprietary and secret information. It is intended only for the use of individual or entity to whom it is sent. Individual or entity agrees to not disseminate or copy this information to anyone other than originally specified without the written consent Allectra GmbH.						1:1				
								Material, Standard Oberfläche (Treatment)	Kanten (edges)	
								Bezeichnung (Title)	Gewicht (weight)	
		Datum	Name	UHV connector 26 pin male		12.69		g		
		Design	20.11.2014	JB	high density SUB-D		Page: 1		Pages: 4	
		Drawn	05.07.2016	FW	Zeichnungsnummer (Drawing No.)		Revision			
		Check			211-MS26H-PK		Format		A4	
Index	Modification	Datum	Name			Datei (File)		C:\PDMStore\IC\PDMStore\		