

POS-NR.	DESCRIPTION	MATERIAL	QTY
1	Countersunk Screw M2X14	Stainless Steel	2
2	Front Plate for SUB-D 50 Pin	Glass Ceramic	1
3	Slotted Cheese Screw 4-40 UNC	1.4301 (X5CrNi18-10)	2
4	Back Plate for SUB-D 50 Pin	Glass Ceramic	1
5	Hexagon Nut M2 DIN934	Stainless Steel	2

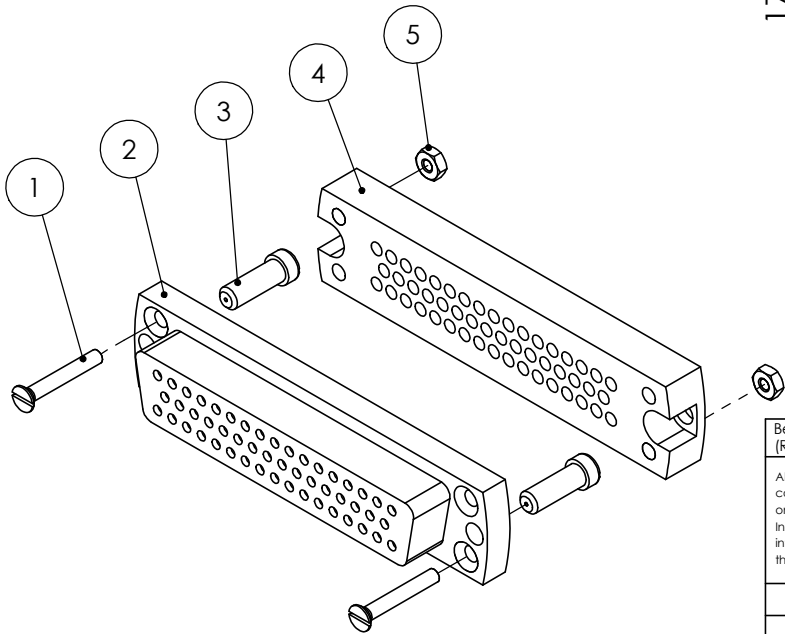
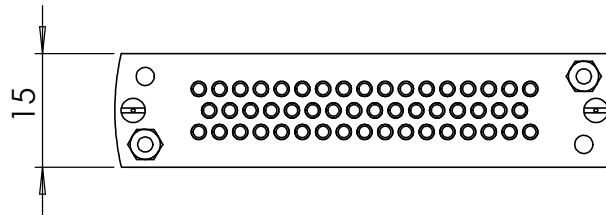
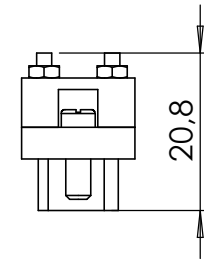
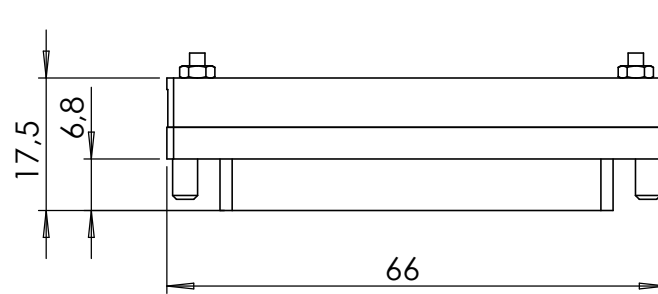
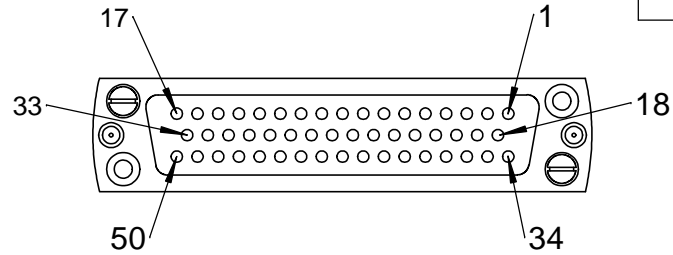

Bemerkungen (Remarks)				Freimaßtoleranz (Standard Toleranz)		Maßstab (Scale)	Rauheit (Roughness)	europ.Projektion				
All informations provided in this drawing is considered to be confidential, proprietary and secret information. It is intended only for the use of individual or entity to whom it is sent. Individual or entity agrees to not disseminate or copy this information to anyone other than originally specified without the written consent Alletra GmbH.				Datum		1:1	Material, Standard Oberfläche (Treatment)	Kanten (edges)				
				Design				23.05.2014		JB	Gewicht (weight) g 28.27	
				Drawn				30.06.2016				
Check						Bezeichnung (Title)		Page: 6	Pages: 6			
								UHV connector 50 pin standard SUB-D				
								Zeichnungsnummer (Drawing No.) 211-FS50-UHV				
								Revision				
Index	Modification	Datum	Name			Datei (File) C:\PDMStore\C\PDMStore\		Format A4				