

POS-NR.	DESCRIPTION	MATERIAL	QTY
1	Countersunk Screw M2X14	Stainless Steel	2
2	Front Plate for SUB-D 50 Pin	PEEK	1
3	Slotted Cheese Screw 4-40 UNC	1.4301 (X5CrNi18-10)	2
4	Back Plate for SUB-D 50 Pin	PEEK	1
5	Hexagon Nut M2 DIN934	Stainless Steel	2

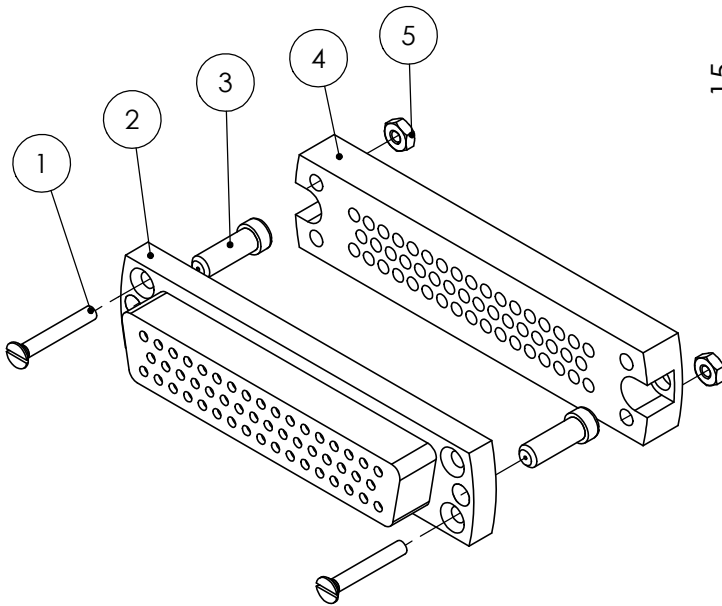

Bemerkungen (Remarks)				Freimaßtoleranz (Standard Toleranz)		Maßstab (Scale)	Rauheit (Roughness)	europ.Projektion			
All informations provided in this drawing is considered to be confidential, proprietary and secret information. If is intended only for the use of individual or entity to whom it is sent. Individual or entity agrees to not disseminate or copy this information to anyone other than originally specified without the written consent Allectra GmbH.				Datum		1:1					
				Design				28.02.2014		JB	
				Drawn				22.06.2016		FW	
Index				Modification		Datum		Name			
								Material, Standard Oberfläche (Treatment)			
								Kanten (edges) 			
								Bezeichnung (Title) <b>UHV connector 50 Pin</b> <b>Standard SUB-D</b>			
								Gewicht (weight) <b>g</b> <b>26.88</b>			
								Page: <b>7</b> Pages: <b>10</b>			
								Zeichnungsnummer (Drawing No.) <b>211-FS50-PK</b>			
								Revision			
								Datei (File) C:\PDMStore\IC\PDMStore\			
								Format <b>A4</b>			

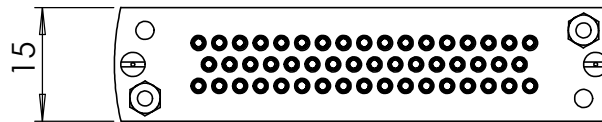
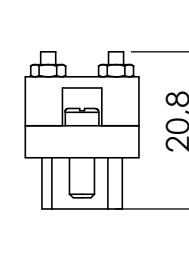
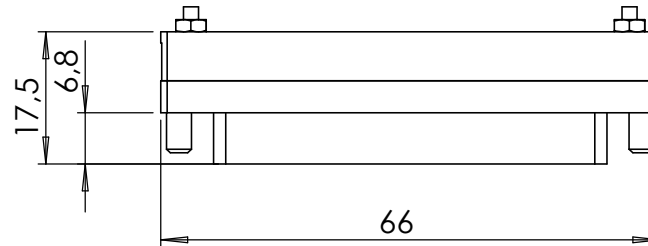
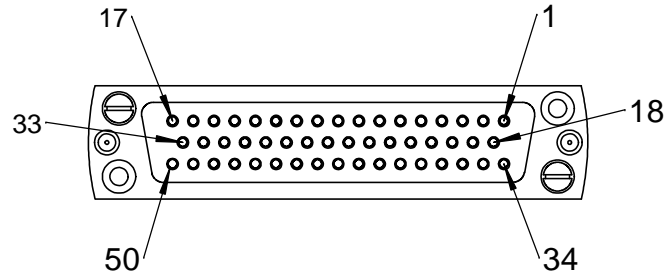