

POS-NR.	DESCRIPTION	MATERIAL	QTY
1	modified flange DN63 CF	1.4404 (316L)	1
2	SUB-D f/t 5 PIN high power	stainless steel	2
3	housing for PEEK + Ceram. Con		1

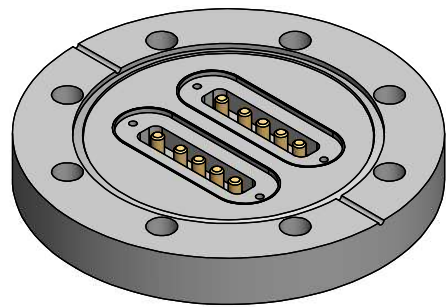
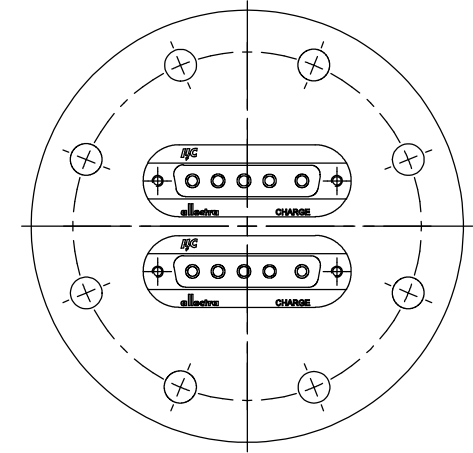
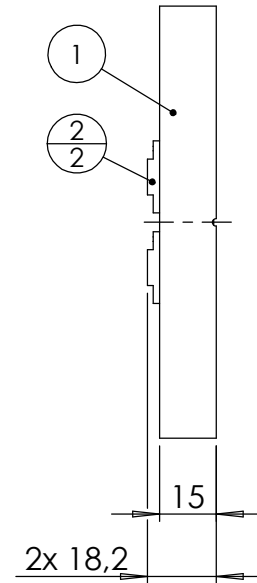
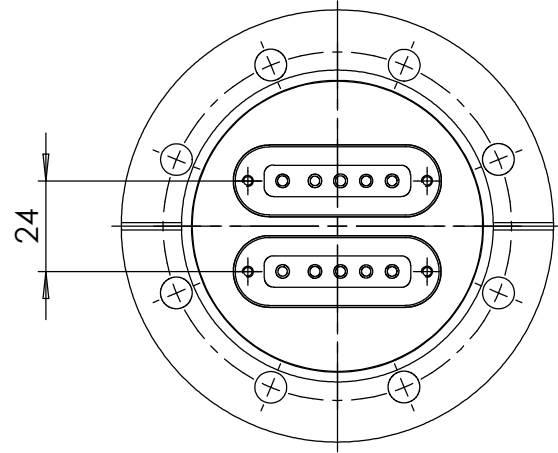

Bemerkungen (Remarks)				Freimaßtoleranz (Standard Toleranz)		Maßstab (Scale)	Rauheit (Roughness)	europ.Projektion
HSG=66 All informations provided in this drawing is considered to be confidential, proprietary and secret information. If is intended only for the use of individual or entity to whom it is sent. Individual or entity agrees to not disseminate or copy this information to anyone other than originally specified without the written consent Alletra GmbH.						1:2		
				Datum	Name	Material, Standard Oberfläche (Treatment)		Kanten (edges)
				Design	25.11.2020	AD	Gewicht (weight) g	
				Drawn	25.11.2020	AD	1124.00	
				Check			Page: 1	Pages: 1
						Bezeichnung (Title)		Revision
						2 off SUB-D f/t, 5 high power pins on flange DN 63CF		
						Zeichnungsnummer (Drawing No.)		
						210-X25-5P-C63-2		
Index				Modification	Datum	Name	Datei (File) C:\PDM-Store\I:\PDM-Store\	
								Format A4